

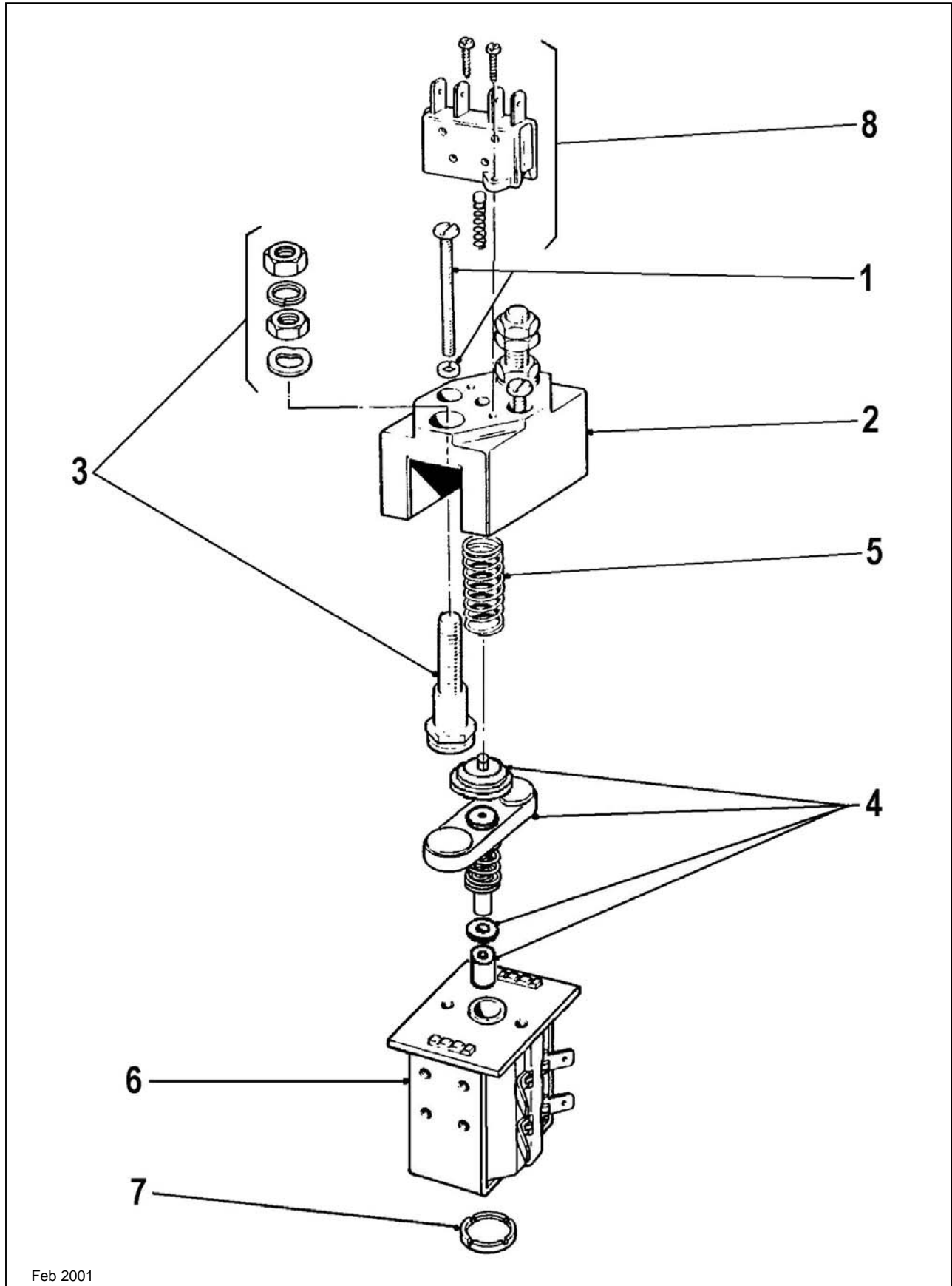

SPARE PARTS FOR
SOLENOID SWITCH TYPE
SW280



Spare parts for Solenoid Switch type SW280

Suffix 'A' indicates contactor built with Auxiliary Contacts.

Suffix 'B' indicates contactor built with Permanent Magnetic Blowouts.

SW280

Item	Part No.	Description	Quantity
1	2155-524	Top Cover Fixing Screw.	2
2	2155-3	Top Cover Moulding (SW280)	1
	2155-65	Top Cover Moulding (SW280B)	1
	2155-3C	Top Cover Moulding (SW280A)	1
	2155-65B	Top Cover Moulding (SW280AB)	1
2A	2155-3J	Top Cover Moulding Enclosed – Optional (SW280)	1
	2155-65G	Top Cover Moulding Enclosed – Optional (SW280B)	1
	2155-3L	Top Cover Moulding Enclosed – Optional (SW280A)	1
	2155-65R	Top Cover Moulding Enclosed – Optional (SW280AB)	1
3	2155-812	Fixed Contact Assembly.	2
2 & 3	2155-590A	Top Cover Moulding with Fixed Contacts (SW280)	1
	2155-590C	Top Cover Moulding with Fixed Contacts (SW280B)	1
	2155-590B	Top Cover Moulding with Fixed Contacts (SW280A)	1
	2155-590D	Top Cover Moulding with Fixed Contacts (SW280AB)	1
2A & 3	2155-590E	Top Cover Moulding Enclosed with Fixed Contacts (SW280)	1
	2155-590G	Top Cover Moulding Enclosed with Fixed Contacts (SW280B)	1
	2155-590F	Top Cover Moulding Enclosed with Fixed Contacts (SW280A)	1
	2155-590H	Top Cover Moulding Enclosed with Fixed Contacts (SW280AB)	1
4	2155-587	Moving Contact Assembly.	1
5**	2065-43__	Return Spring	1
6**	2155-588__	Assembled Magnet Frame & Coil.	1
7	2180-246	End Cap	1
8	2155-352	Auxiliary Contact Kit (SW280A)	1

**When ordering these items, please state full type number of contactor for which items are required.

Note: M10 nuts to item 3 should be tightened to a torque of 13.4 to 14.6 Nm.



ALBRIGHT INTERNATIONAL LTD
 125 RED LION ROAD - SURBITON
 SURREY KT6 7QS - ENGLAND
 TEL: +44 (020) 8390 5357
 FAX: +44 (020) 8390 1927
 WEBSITE: www.albright.co.uk